

PANEL MOUNTING

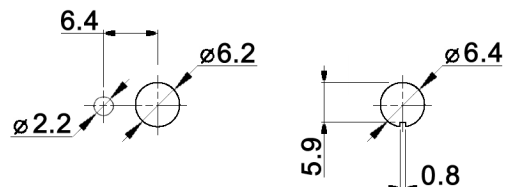

CONTACT ARRANGEMENT

code for x	function	toggle towards keyway	toggle opposite to keyway
D	On-On	1-2	2-3
F	Mom-On		

code for x	function	toggle towards keyway	toggle in center	toggle opposite to keyway
E	On-Off-On			
G	Mom-Off-Mom	1-2	open	2-3
H	Mom-Off-On			

Specifications:

Contact rating: 3A, 250V AC / 6A, 125V AC
 4A, 30V DC / 5A, 12V DC
 6A, 6V DC
Contact resistance: 20mOhm max.
Insulation resistance: 1 000MOhm min. at 500V DC
Dielectric strength: 1 500V, 50Hz for the duration of 1 minute
Operating temperature: -45°C to +140°C
Mechanical life: min. 200 000 cycles
Soldering conditions: hand-soldering: max.: 420°C, 3sec., 60W
 auto-soldering: max.: 270°C, 5sec.
Mounting instruction: max. torque: 49Ncm
Material: Contact portion: solid silver
 Other conducting parts: brass, 10µm silver plated over 1.5µm nickel
 Case: DAP
 Housing: stainless steel, CNS9265
 Bushing: copper alloy, C3604BD nickel plated
 Actuator: copper alloy, C3604BD chrome plated
Included accessories: 2 pcs. nut M6x0.75, nickel plated, 9mm wrench size
 1 pc. tooth washer
 1 pc. locking washer



Tolerances: 0.00: ±0.25mm 0.0: ±0.40mm		Date	Name	<h1>MTA 106 x</h1>
		02/09	dr	
Material	07/11	dr		<h1>30 17 11</h1>
Dimension	01/11	dr		
Panel mounting	05/10	dr		
Switch function	04/09	dr		
Modifications	Date	Name		
			knitter-switch	Page 1/1